

INCH-POUND

MIL-DTL-24653/5A(SH)

28 July 2020

SUPERSEDING

MIL-H-24653/5(SH)

30 May 1985

DETAIL SPECIFICATION SHEET

HASP, HIGH SECURITY, SHROUDED, FOR SHIPBOARD DOORS AND HATCHES USING HIGH SECURITY PADLOCK, STYLE 5

This specification sheet is approved for use by the Naval Sea Systems Command and is available for use by all Departments and Agencies of the Department of Defense.

The requirements for acquiring the product described herein shall consist of this specification sheet and MIL-DTL-24653.

REQUIREMENTS:

The configuration requirements applicable to a style 5 hasp shall conform to [figure 1](#).

Installation instructions: Each hasp assembly shall be furnished with installation instructions as shown on [figure 2](#).

AMSC N/A

FSC 5340

DISTRIBUTION STATEMENT A. Approved for public release. Distribution is unlimited.

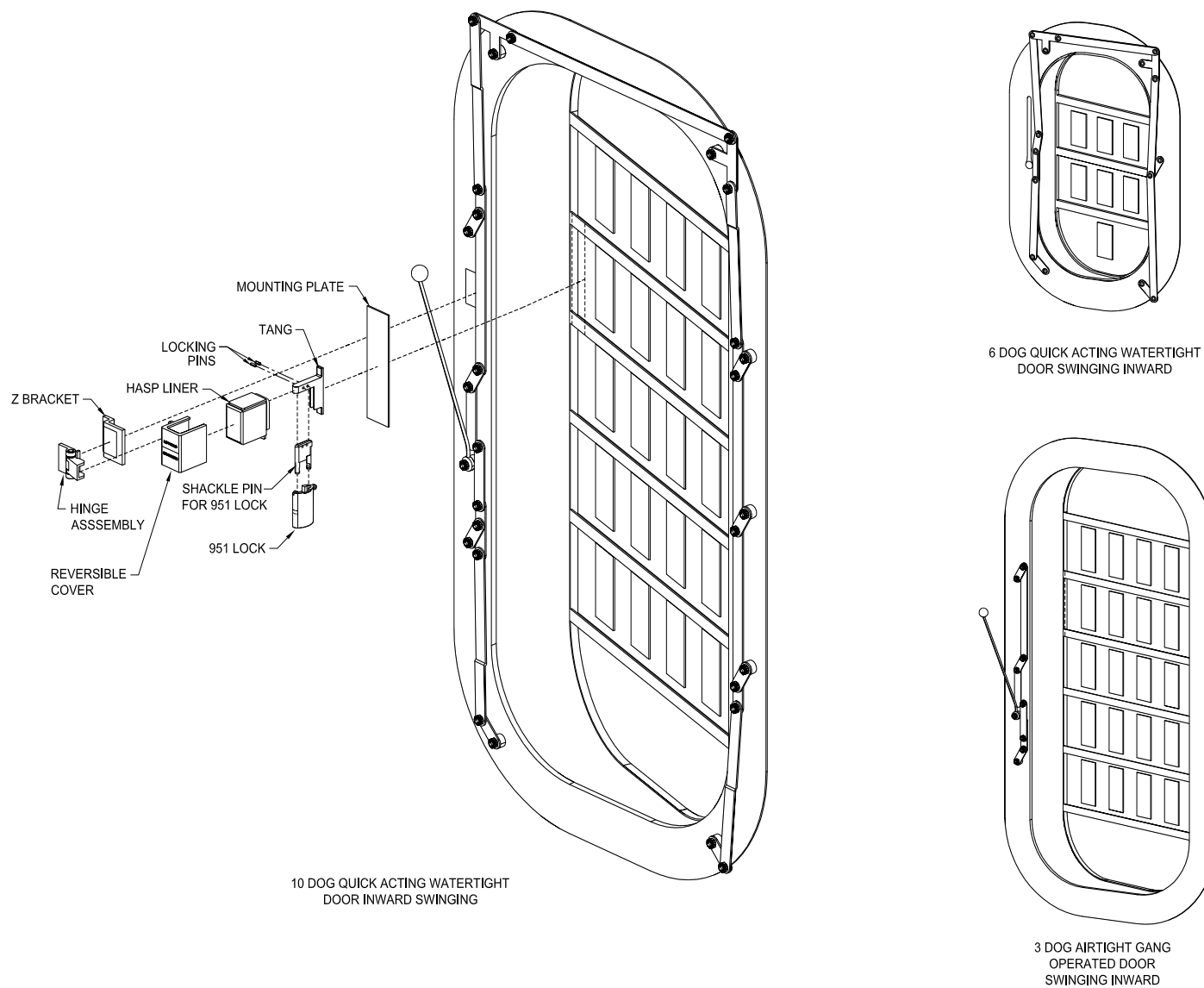

FIGURE 1. Configuration for left-hand or right-hand hinged quick acting watertight doors swinging in to open, style 5.

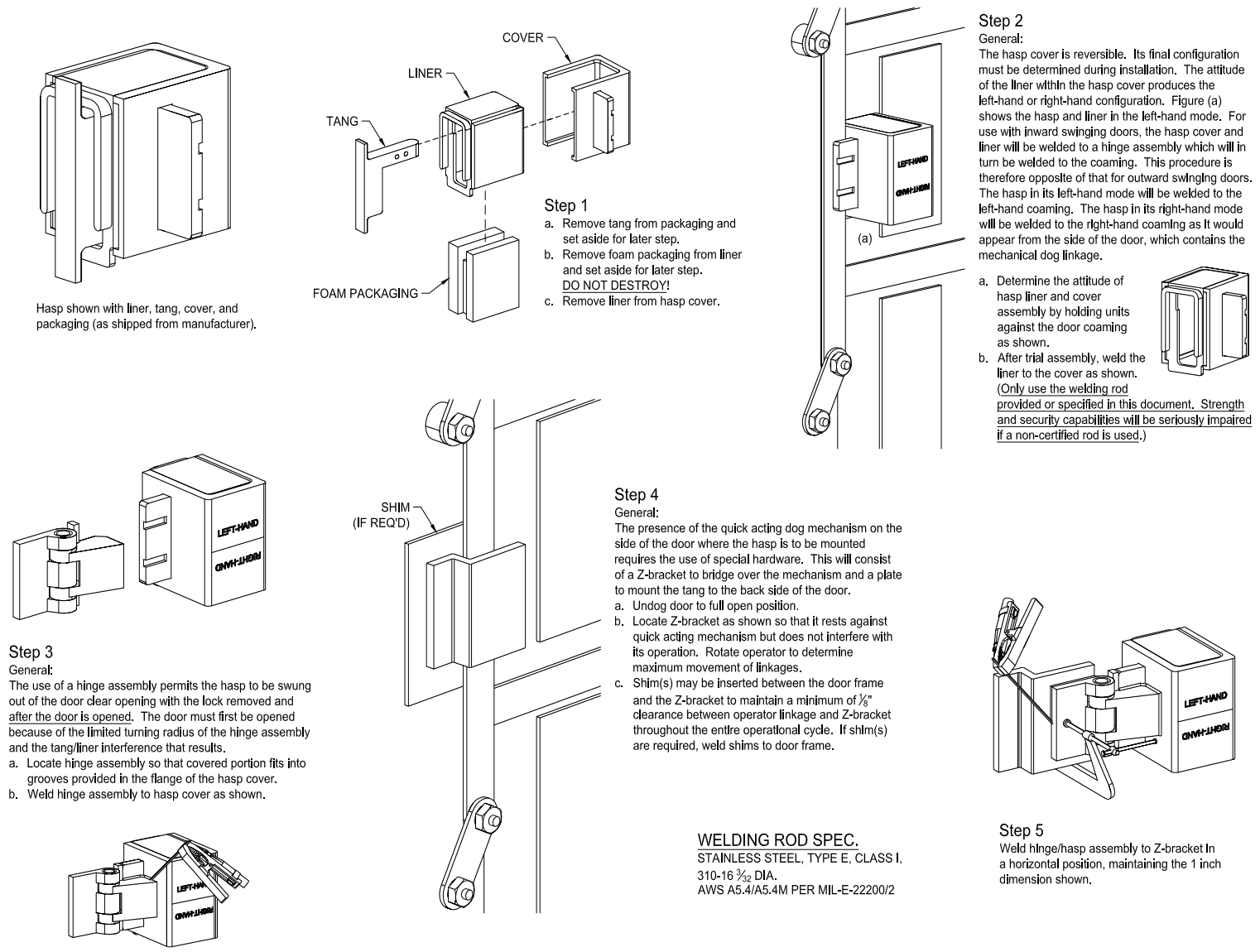
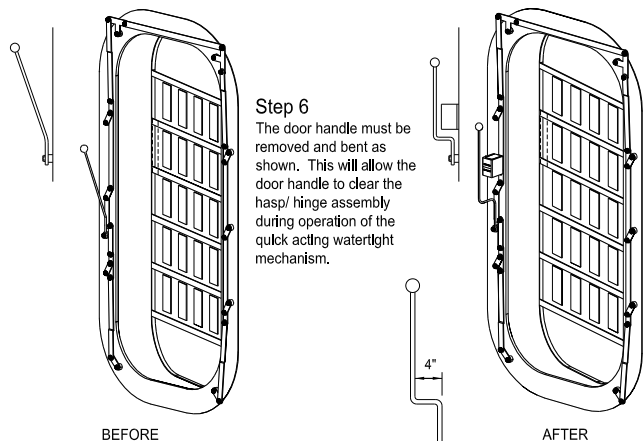
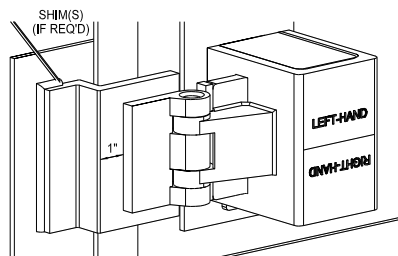

FIGURE 2. Installation procedures for left-hand or right-hand hinged quick acting watertight doors swinging in to open, style 5.



Step 6

The door handle must be removed and bent as shown. This will allow the door handle to clear the hasp/hinge assembly during operation of the quick acting watertight mechanism.



Step 7

- Locate Z-bracket on frame as shown. Z-bracket/hinge/hasp assembly should be parallel to door stiffeners.
- Undog door and verify that assembly does not contact quick acting mechanism during the process.
- Tack weld the Z-bracket to the door frame, as shown.
- Rotate the quick acting mechanism through a complete cycle to assure clearance between the Z-bracket and mechanism.

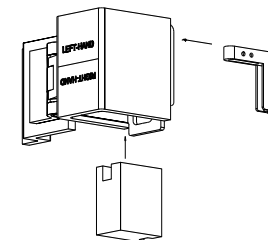

Step 8

General:

The hasp is designed to provide a large degree of hasp/lock flexibility. Correct installation of the tang is important to ensure the maximum of flexibility.

- Reinsert the foam packaging into the liner as shown.
- Reinsert the tang into the packaging.

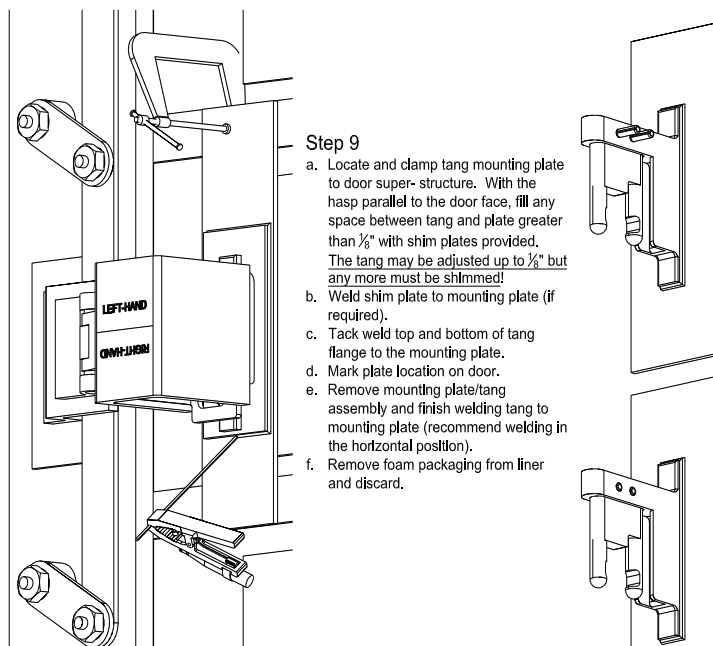

Step 9

- Locate and clamp tang mounting plate to door super-structure. With the hasp parallel to the door face, fill any space between tang and plate greater than $\frac{1}{8}$ " with shim plates provided. The tang may be adjusted up to $\frac{1}{8}$ " but any more must be shimmed!
- Weld shim plate to mounting plate (if required).
- Tack weld top and bottom of tang flange to the mounting plate.
- Mark plate location on door.
- Remove mounting plate/tang assembly and finish welding tang to mounting plate (recommend welding in the horizontal position).
- Remove foam packaging from liner and discard.

Step 10

General:

The hasp is designed to be used with the Sargent and Greenleaf, Inc., 951 lock. The 951 lock meets the high security requirements when used with the hasp. The lock requires its shackles to be removed (by a locksmith).

- Insert the set of pins selected into the tang and drive in locking pins.
- Reposition mounting plate/tang assembly and clamp the assembly to the door as previously marked.
- Close and dog the door. With hasp body encompassing the shackle pins, assemble 951 lock, as appropriate, to the shackle pins. Assume that there is no interference between the lock body and the hasp body during the locking process, or between the tang and hasp liner while opening and closing the door. Interference may be eliminated by adjusting the mounting plate on the door so that the shackle pins/tang assembly is centered in the opening in the back side of the hasp liner.
- Undog door and cycle door, hasp, quick acting watertight mechanism and lock through several operational cycles. The units operate satisfactory when: (1) there is no interferences between the door, hasp, and quick acting watertight door mechanism when opening or closing; and (2) there is no interference during assembly or disassembly of the lock body.
- Full weld Z-bracket to door frame.
- Repeat steps c and d above.
- The mounting plate should be welded securely to door stiffeners.

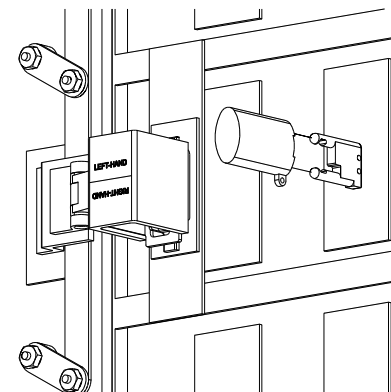

Step 11

General:

A second set of shackle pins are provided to allow the locks to be stored outside the hasp. This set of pins may be installed anywhere in the door or coaming at the discretion of the operating personnel.

- Hold or clamp shackle pins to selected surface.
- Weld pins in place.

FIGURE 2. Installation procedures for left-hand or right-hand hinged quick acting watertight doors swinging in to open, style 5 – Continued.

CHANGES FROM PREVIOUS ISSUE: Marginal notations are not used in this revision to identify changes with respect to the previous issue due to the extent of the changes.

CONCLUDING MATERIAL

Custodian:
Navy – SH

Preparing activity:
Navy – SH
(Project 5340-2020-019)

Review activity:
DLA – IS

NOTE: The activities listed above were interested in this document as of the date of this document. Since organizations and responsibilities can change, you should verify the currency of the information above using the ASSIST Online database at <https://assist.dla.mil>.