

AA-F-363D
AMENDMENT 4
APRIL 6, 2015
SUPERSEDING
AMENDMENT 3
APRIL 20, 2007

FEDERAL SPECIFICATION

FILING CABINET, SECURITY, MAPS AND PLANS, GENERAL FILING AND STORAGE

The General Services Administration has authorized the use of this amendment, which forms a part of AA-F-363D, dated June 1, 2001, by all federal agencies.

Page 1

Paragraph 1.2.1, under class 6, Type II, delete "Size III".

Paragraph 1.2.1, under class 6, Type II, add "Size VI".

Paragraph 1.2.1 Delete address for GSA and substitute "General Services Administration, Office of General Supplies and Services, Engineering and Cataloging Division (QSDEC), 1800 F Street., NW Washington DC,20405."

Page 2

Paragraph 1.2.3, last sentence, delete "FF-L-2740A" and substitute "FF-L-2740".

Page 2

Paragraph 2.1, Federal Specifications:, delete last line and substitute "FF-L-2740B – Locks, Combination, Electromechanical".

FSC 7110

Delete the first entry in Paragraph 2.2 (American National Standards Institute (ANSI) / American Society for Quality (ASQ)) in its entirety and substitute the following:

2.2 American Society for Quality (ASQ):
ASQ Z1.4 - Sampling Procedures and Tables for Inspection by Attributes

(Private sector and civil agencies may purchase copies of this voluntary standard from the American Society for Quality, P. O. Box 3005, Milwaukee, WI 53201-3005.)

Paragraph 3.2.4, delete

Gray Color – No. 26134
Black Color – No. 27040

And substitute

Gray – Color No. 26134
Black – Color No. 27040

Paragraph 3.3.3.2, delete “Size III” from title, first sentence, and its line in Table I.

Add the following new Paragraph:

3.3.3.4 Class 6, Size VI Aircraft safe. The safe shall have minimum inside dimensions of 15 inches in height, 12 inches in width and 9 inches deep. The safe shall open from the top. The safe shall have a lid attenuation device to limit the speed of lid closure and prevent injury. The lid handle shall meet the requirements of paragraph 3.3.5.1. The container shall have ½ inch mounting holes drilled 1 inch from each corner in the bottom of the container. In lieu of the weight requirements of Paragraph 3.3.4, the size VI safe shall have a maximum weight of 60 pounds.

Add the following to the end of Paragraph 3.3.4:

If the container weighs less than 250 lbs, the container shall have provisions for securely mounting the container.

Page 6

Paragraph 3.4, last sentence, delete "FF-L-2740A" and substitute "FF-L-2740".

Page 6

Add the following paragraphs:

3.4.3 Lock box. The door shall have a six sided lock box welded to the front plate of the door face constructed in such a way that it provides for the protection of the combination lock and its interface with the bolt work as specified in paragraph 3.10. The door and lock box shall be designed such that the lock mounting plate is a minimum of 1" from the lock dial ring mounting surface.

3.4.3.1 Internal dimensions. The lock box shall have internal dimensions of 2-1/2" x 5" x 1-1/2" to accommodate the combination lock, lock bolt and security container bolt work.

3.4.3.2 Material. The lock box shall be constructed of a minimum of 3/8" hardened steel on all sides. A lock box may be constructed with additional features and/or materials that will pass the covert entry tests of 3.10.

3.4.3.3 Lock mounting plate. A 1/4" thick combination lock mounting plate drilled and tapped for four (4) 1/4-20 mounting holes (through the plate as in figure I) and with a 3/8" spindle hole for the combination lock shall be welded to the inside of the lock box. The lock mounting surface of the lock mounting plate shall have a flatness tolerance of 0.003 inch per inch.

3.4.3.4 Lock box removable plates. To allow access to the combination lock for installation and maintenance purposes, a removable 1/4" hardened steel plate configured to slide into a captured slot of the lock box such that a punching force through the spindle hole cannot drive the plate from the lock box shall be provided. In addition, a second steel filler plate shall be provided if required to fill any voided space between the back of the combination lock and the 1/4" steel plate.

Page 6

Delete paragraph 3.5 in its entirety and substitute the following:

3.5 Intentionally left blank.

Page 8

Paragraph 3.10, delete "Surreptitious and forced entry." and substitute "Surreptitious, covert and forced entry."

Page 8

Delete Paragraph 3.12 in its entirety and substitute the following:

3.12 Identification labels. Each cabinet supplied under a contract or order under this specification shall bear metallic labels showing the information specified hereunder. Labels shall be attached with a durable adhesive sufficient to preclude removing the label without destroying the label. Regardless of the method used, the label attachment shall not degrade the cabinet security.

Page 8

Add the following to the end of Paragraph 3.12.3:

If the container weighs less than 250 lbs, a separate label shall be required stating that the container must be securely mounted by utilizing the provided attachment method in order to maintain GSA approval.

Page 9

Delete Paragraph 3.12.4 in its entirety and substitute the following:

3.12.4 Number label. All security cabinets under this specification shall have a number label affixed to the front face of the product. The label attachment shall not degrade the cabinet security. The label shall be mounted on the cabinet frame above or to the left side of the door. The label shall be nominal 0.020 inch thick, satin finished aluminum and shall be 2-1/2 by 11/16 inches. The label numbering system shall be established by the manufacturer to provide non-repetitive numbers. The label characters (numbers or letters) shall be minimum 3/16 inches high and shall be embossed.

Page 9

Add the following Paragraph:

3.12.5 Warning label. A warning label shall be affixed to the inside face of the door. The label shall show, in red lettering not less than 1/8 inch high, the following:

Notice: Any modification of this container not in accordance with Federal Standard 809 will invalidate the GSA approval and the GSA approval label shall be removed.

Page 12

Paragraph 4.4.6,

Delete (C) and substitute:

(c) Drop tests – 4.4.8.3

Add (g) Finish test – 4.4.8.7

Page 13

Paragraph 4.4.8.5.1, delete in its entirety and substitute the following:

4.4.8.5.1 Tool size and weight limits. The tools and devices shall be capable of being carried in two cases or bags, each case or bag not exceeding 1.5 cubic feet in volume. The total weight of the tools used in a single test shall not exceed 150 pounds, exclusive of the weight of the case. The test tools and devices selected for a particular attempt shall be weighed prior to commencement of the test.

Add the following new paragraph:

4.4.8.5.1.1 Surreptitious entry tools and devices. Tools and devices used in the surreptitious entry tests are unlimited.

Add the following new paragraph:

4.4.8.5.1.2 Covert entry tools and devices. Tools and devices used in the covert entry tests shall be limited as specified below. Power tools, electrically or battery powered shall be commercially available equipment, and shall be limited to drills not exceeding 5000 rpm. Pressure rigs may be used, with a lever arm not exceeding 30 inches. Tools may be reasonably modified, (e.g. special chucks on drills, ground or shaped chisels or pry bars, etc.). Electrical tools shall be able to operate on electricity available in normal office space. Devices for the application of heat shall be limited to single tank propane, butane, or equivalent devices which fall within the weight and dimension limits specified above.

Acetylene, MAPP or equivalent shall not be used. Electronic arc or any form of burn bars, oxidizer assisted products or explosives shall not be used.

Add the following new paragraph:

4.4.8.5.1.3 Forced entry tools and devices. The tools and devices used for forced entry tests shall be limited to non-powered tools only.

Page 14

Paragraph 5.1.1, delete “Filing cabinets, with drawers closed, shall” and substitute “Filing cabinets shall”.

Page 15

Paragraph 6.1, delete last sentence.

Paragraph 6.3 – Delete GSA address and substitute “General Services Administration, Office of General Supplies and Services, Engineering and Cataloging Division (QSDEC), 1800 F Street., NW Washington DC,20405.”

Add the following figure:

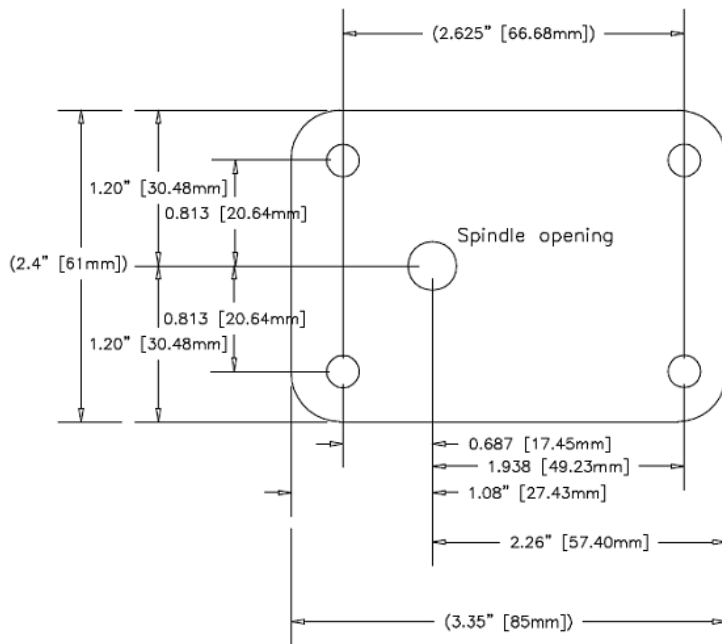

Tolerances:
XX.XX ±0.01 [±0.25 mm]
XX.XXX ±0.005 [±0.13 mm]

Figure I
Schematic arrangement of lock case holes.

Preparing Activity:
GSA-FAS

FSC 7110